

# SHIRE OF MERREDIN COMMUNITY NEWS & INFORMATION

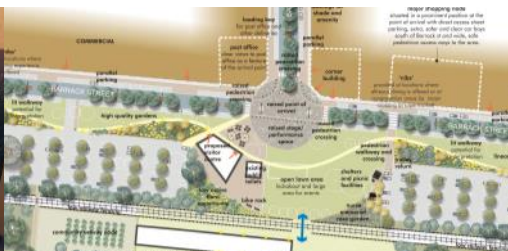

## Visitor Centre boon as funding announced

The Central Wheatbelt Visitor Centre in Merredin is a successful recipient of funding in Round 3 of the *Royalties for Regions* Regional Visitor Centre Sustainability Grant Program (RVCSGP).

“Research [...] shows that people spend more time and money in an area when they use a visitor centre, therefore it’s vital that we help them become more financially viable,” said Tourism Minister Paul Papalia of the RVCSGP.

The funding will be put towards a number of initiatives at the Visitor Centre including a merchandise and retail fitout to include a dedicated book display area, public notice board upgrade, visitor count and seating with a phone/tablet recharging station and more historical images on the front window and signage; installation of public wifi; and training for staff to complete Certificate III in Tourism and coordination of the Tourism Council WA to deliver workshops to upskill staff, stakeholders and members.

*Right: This Glass Display Case was funded in Round 2 to upgrade the visitor centre merchandise space.*

## In This Issue

Visitor Centre funding announced

2018 Council meeting dates

Shire Christmas opening hours

Whitfield Way blocks available

Public water supplies in bushfire

Q & A: overgrown yards

Q & A: What happens to dogs that end up in the pound?



## December Council Meeting

The next Ordinary Council Meeting will be held at the Shire Administration Building, in Council Chambers, on Tuesday 19 December 2017 and will commence at 3:00pm. Members of the public are welcome to attend. The Agenda will be available to view on Council’s website on Monday 18 December 2017.

**2018 Council meeting dates**

The 2018 Ordinary Council Meetings will be held on the following dates:

- Tuesday 16 January**
- Tuesday 20 February**
- Tuesday 20 March**
- Tuesday 17 April**
- Tuesday 15 May**
- Tuesday 19 June**
- Tuesday 17 July**
- Tuesday 21 August**
- Tuesday 18 September**
- Tuesday 16 October**
- Tuesday 20 November**
- Tuesday 18 December**

Council meetings are held at the Shire Administration Centre, cnr King & Barrack Streets, Merredin, commencing at 3.00pm.

**Shire opening hours over Christmas**

Over the Christmas and New Year period, most Shire facilities will be operating with modified hours as follows:

	Administration	Visitor Centre	Cummins Theatre	Library	Swimming Pool	Landfill Site
<b>Fri 22 Dec</b>	8:30am-12:00pm	8:30am-4:30pm	10:00am-12:00pm	10:00am-5:00pm	12:00pm-6:00pm	10:30am-4:30pm
<b>Sat 23 Dec</b>	CLOSED	CLOSED	CLOSED	CLOSED	12:00pm-6:00pm	10:00am-3:00pm
<b>Christmas Day</b>	CLOSED	CLOSED	CLOSED	CLOSED	CLOSED	CLOSED
<b>Boxing Day</b>	CLOSED	CLOSED	CLOSED	CLOSED	1:00pm-6:00pm	CLOSED
<b>Wed 27 Dec</b>	CLOSED	10:00am-2:00pm	CLOSED	CLOSED	12:00pm-6:00pm	10:30am-4:30pm
<b>Thur 28 Dec</b>	CLOSED	10:00am-2:00pm	CLOSED	CLOSED	12:00pm-6:00pm	10:30am-4:30pm
<b>Fri 29 Dec</b>	CLOSED	10:00am-2:00pm	CLOSED	CLOSED	12:00pm-6:00pm	10:30am-4:30pm
<b>Sat 30 Dec</b>	CLOSED	CLOSED	CLOSED	CLOSED	12:00pm-6:00pm	10:00am-3:00pm
<b>New Years Eve</b>	CLOSED	CLOSED	CLOSED	CLOSED	12:00pm-6:00pm	10:00am-3:00pm
<b>New Years Day</b>	CLOSED	CLOSED	CLOSED	CLOSED	12:00pm-6:00pm	CLOSED
<b>Tue 2 Jan</b>	8:30am-4:30pm	8:30am-4:30pm	CLOSED	10:00am-2:00pm	12:00pm-6:00pm	10:30am-4:30pm
<b>Wed 3 Jan</b>	8:30am-4:30pm	8:30am-4:30pm	CLOSED	10:00am-2:00pm	12:00pm-6:00pm	10:30am-4:30pm



Above: Lenihan Park, adopted and designed by St Mary's students, is officially opened

**Whitfield Way - 4 lots remaining**

In March/April 2017 Council called for tenders for the remaining blocks in the Whitfield Way Stage 2 residential subdivision, with 2 lots sold from that process. Since then a further 3 lots have sold, leaving only 4 lots remaining. The blocks range from 5,000m<sup>2</sup> to 6,000m<sup>2</sup>, are zoned Special Residential, serviced with underground power and water and have sealed roads.

If you've been thinking of acquiring one of these blocks, get in quick. Contact Vanessa on 9041 1611 for further information.

**COMMUNITY EVENTS**

<b>Every Tues</b>	<b>10:30am</b>	<b>Story-time at the Library</b>	<b>Library</b>	<b>Free</b>
<b>Every Wed</b>	<b>6:30pm</b>	<b>Bingo night</b>	<b>Rec Centre</b>	<b>Up to \$30</b>
<b>Every Thurs</b>	<b>10:00am</b>	<b>Walking group</b>	<b>Rec Centre</b>	<b>Free</b>
<b>1 December</b>		<b>Get your scrap materials Christmas Tree in!</b>	<b>Visitor Centre</b>	<b>Free</b>
<b>14 December</b>	<b>5:00pm</b>	<b>Gala Night</b>	<b>Barrack Street</b>	<b>Free</b>
<b>19 December</b>	<b>3:00pm</b>	<b>Council Meeting</b>	<b>Council Chambers</b>	<b>Free</b>
<b>18 - 22 Dec</b>		<b>Christmas Wonderland at the Theatre</b>	<b>Cummins Theatre</b>	<b>\$7</b>
<b>21 December</b>	<b>7:30pm</b>	<b>Have Yourself a Barry Little Christmas</b>	<b>Cummins Theatre</b>	<b>\$25/\$20</b>

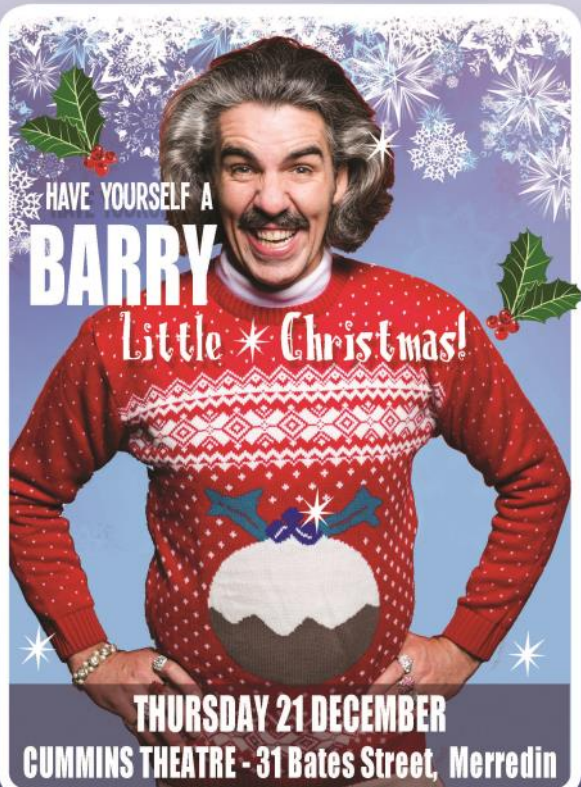

HAVE YOURSELF A  
**BARRY**  
Little \* Christmas!

**THURSDAY 21 DECEMBER**  
CUMMINS THEATRE - 31 Bates Street, Merredin

7:30PM START | SHOW \$25/\$20 | DINNER \$25  
TICKETS FROM CENTRAL WHEATBELT VISITORS CENTRE OR CUMMINSTHEATRE.COM.AU  
WWW.FACEBOOK.COM/MRBARRYMORGAN



**Gala Night**

Christmas Shopping \* Entertainment \* Market Stalls  
Christmas Carols \* Meet Santa

**14 December**  
Barrack Street 5:00pm - 9:00pm

For enquiries contact  
Central Wheatbelt Visitor Centre on 9041 1666

MAKE A  
*recycled Christmas Tree*



PUT YOUR CREATIVE TALENTS TO WORK THIS YEAR TO MAKE A CHRISTMAS TREE TO BE DISPLAYED IN THE WINDOW OF THE CENTRAL WHEATBELT VISITOR CENTRE IN DECEMBER.

use corbs, ties, plastic bottles, tubes, paper, found objects -  
you're only limited by your imagination!

TREES ARE LIMITED TO 90CM HIGH, MUST BE FREESTANDING AND (IF LIT) BATTERY OPERATED

**CREATE A CHRISTMAS TREE FROM RECYCLED MATERIALS**

NAME:.....  
PHONE:.....  
EMAIL:.....  
NAME/DESCRIPTION OF TREE:.....  
TREE MADE FROM:.....

TREES TO BE DELIVERED TO CENTRAL WHEATBELT VISITOR CENTRE FRIDAY 1ST DECEMBER BETWEEN 8.30AM AND 4.30PM  
AND COLLECTED FRIDAY 12 JANUARY 2018 BETWEEN 8.30AM AND 4.30PM  
FOR MORE INFO, PLEASE CONTACT ROBYN OR CARINA AT THE VISITOR CENTRE ON 9041 1666 OR VISITOR@MERREDIN.WA.GOV.AU

THE CUMMINS THEATRE PRESENTS

**Christmas Wonderland**



ALL TICKETS  
**\$7**  
PER SESSION

**DECEMBER 18 - 22**

THE CUMMINS THEATRE IS BEING TRANSFORMED INTO THE NORTH POLE AND YOU ARE INVITED! EACH DAY THERE IS A DIFFERENT CRAFT ACTIVITY FOLLOWED BY FUN IN THE SNOW, VISITS FROM SANTA, AND LOTS OF CHRISTMAS FUN!

TICKETS AVAILABLE FROM THE CENTRAL WHEATBELT VISITORS CENTRE OR ONLINE AT  
WWW.CUMMINSTHEATRE.COM.AU





*The Merredin community handmade poppies were planted again for Remembrance Day, led by the Merredin 510 Army Cadet Unit.*

## Public water supplies in a bushfire

The Water Corporation and the Department of Fire & Emergency Services have issued a reminder ahead of bushfire season not to rely on public water supplies in the event of a bushfire.

Loss of electricity may cause pumps that transfer water to Water Corp storage tanks to fail, and they may not be able to respond to system failures in areas deemed unsafe for their crews to enter.

In the event of a bushfire, if residents choose to stay and defend their homes it's imperative that they have an independent water supply and their own pumping capability.

For more information, visit the Water Corporation website ([www.watercorporation.com.au/water-supply/bushfires-and-water-supply](http://www.watercorporation.com.au/water-supply/bushfires-and-water-supply)) or the Department of Fire & Emergency Services website ([www.dfes.wa.gov.au](http://www.dfes.wa.gov.au))

## Q&A - Fire hazard in overgrown yards

**Q: What can be done to make home owners/occupiers maintain overgrown yards? It's a fire hazard.**

A: All owners or occupiers of land in the Shire are required to clear and maintain appropriate firebreaks between 1st November and 16th March. A \$250 fine may be issued if this requirement is not met.

The Firebreak Order, which outlines the specific requirements for different types of land in the Shire, is sent out annually with the rates notice. You can also view it at the Shire website or pick up a copy from the Shire office.

The Ranger has recently completed his annual firebreak inspections and the last of the infringements have been issued. If you still have concerns about a specific property and would like to lodge a complaint, you can do so by emailing the Ranger direct at [ranger@merredin.wa.gov.au](mailto:ranger@merredin.wa.gov.au).

## Q&A - What happens to dogs that end up in the pound?

**Q. What happens to the dogs that end up in the pound? I've heard they're put down if not claimed.**

A. When the Ranger picks up a stray dog, in most cases they will be microchipped and registered and we can locate the owner fairly quickly. If the dogs aren't registered, we'll advertise on Facebook in an attempt to track down an owner.

If an owner doesn't come forward, most dogs will be rehomed through a charity based in Northam. We prefer not to rehome dogs locally, as this can result in conflict between old owners and new owners.

Dogs and domestic cats are held for a period of 7 days, during which time they are assessed for temperament and behaviour problems with a view to being rehomed. A very high percentage of dogs and cats are indeed rehomed but some animals are not deemed to be suitable for a number of reasons and are not returned to a community.